

RAISED PANEL PROFILES

Go West!

When ordering veneer MDF panel, use 690 as the panel profile.

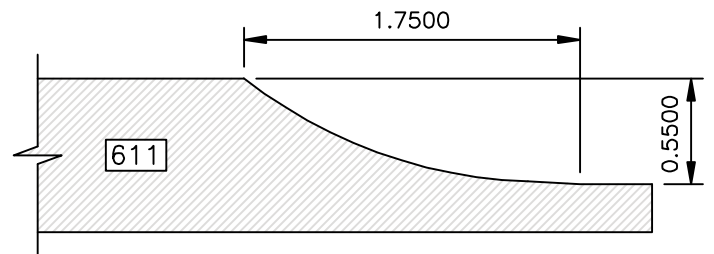
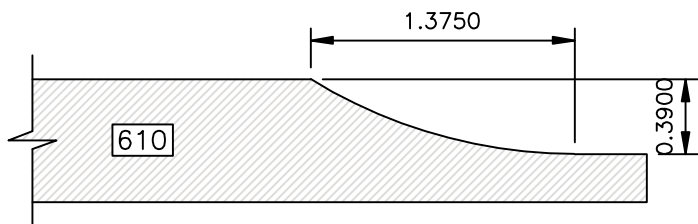
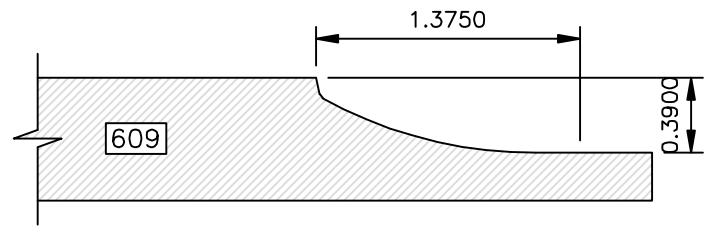
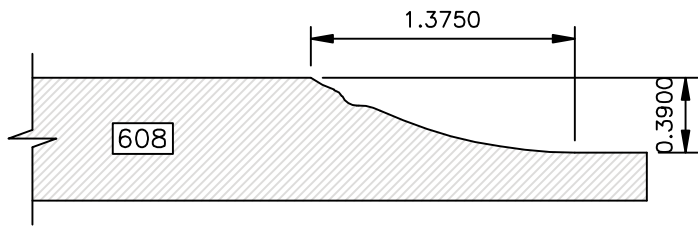
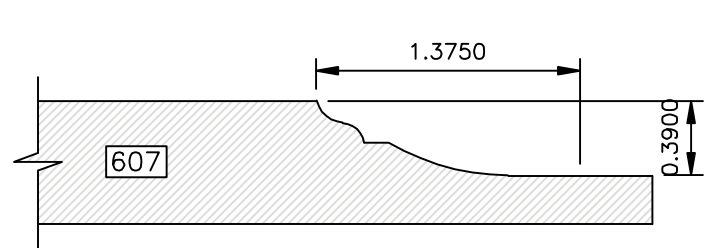
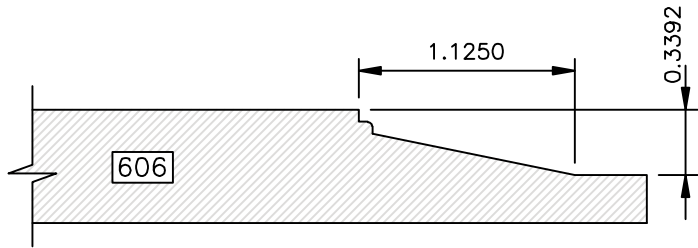
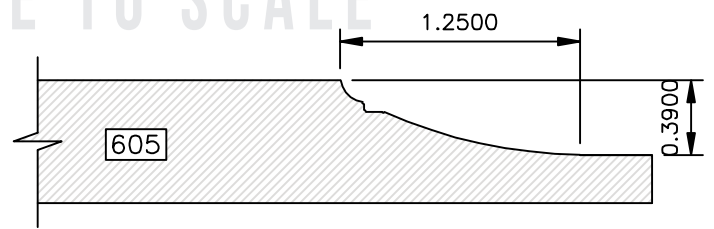
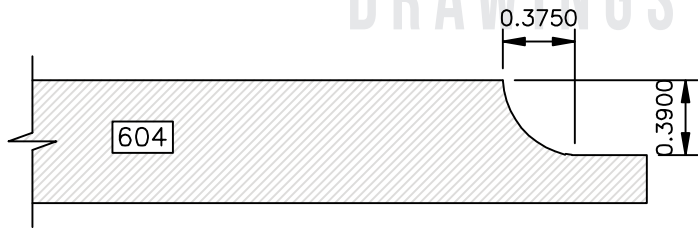
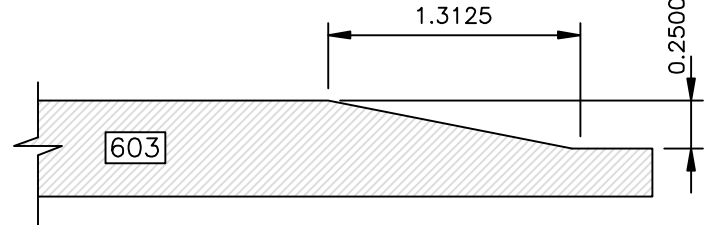
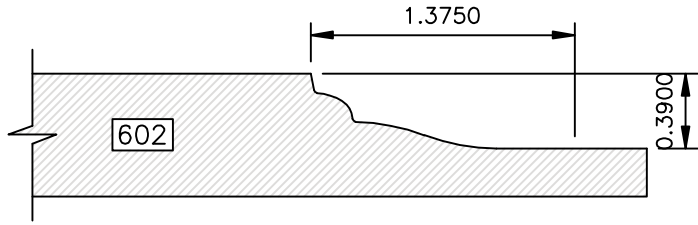
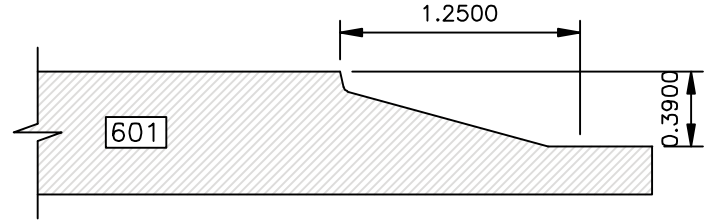
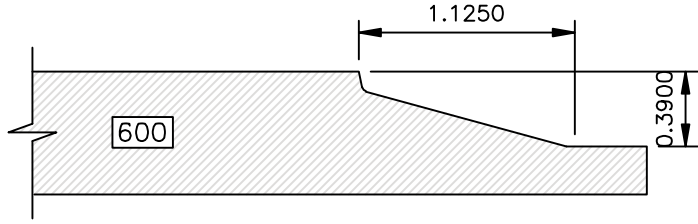

DRAWINGS ARE TO SCALE

Available in 1" Thick Only

RAISED PANEL PROFILES

When ordering veneer MDF panel, use 690 as the panel profile.

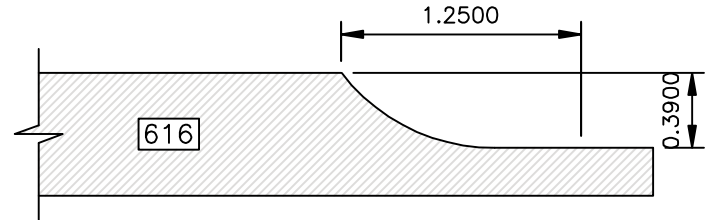
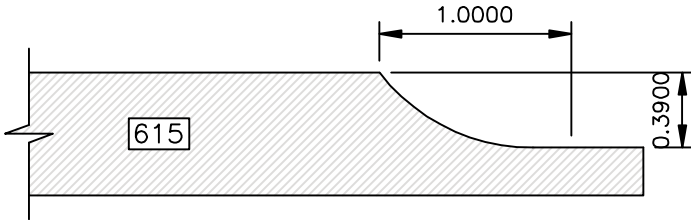
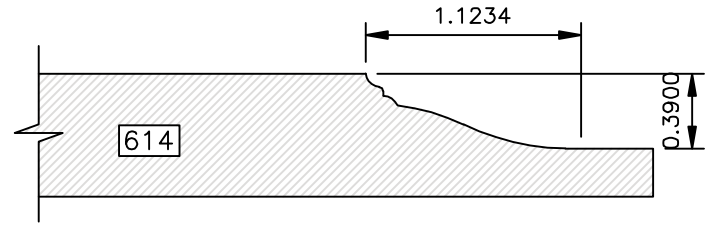
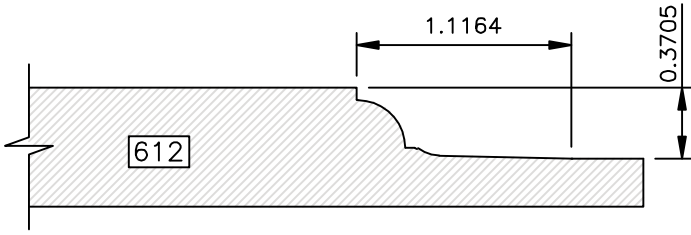

DRAWINGS ARE TO SCALE

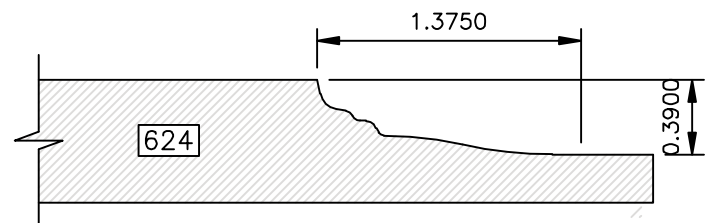
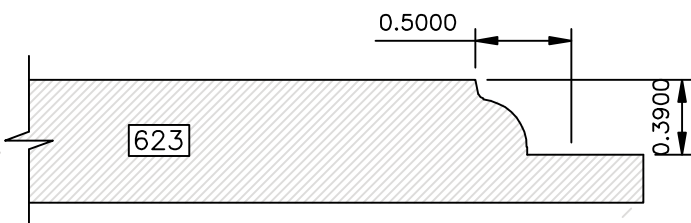
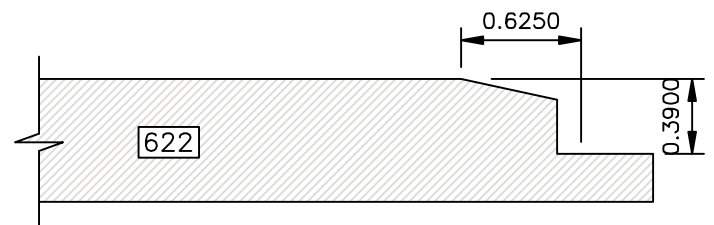
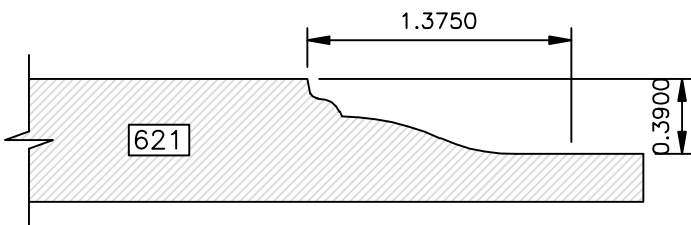
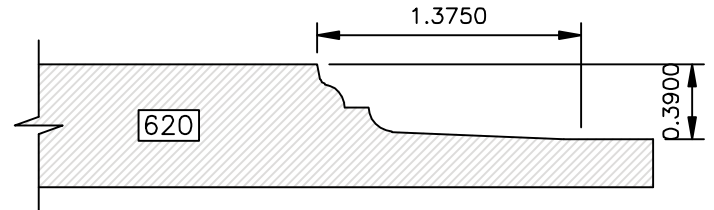
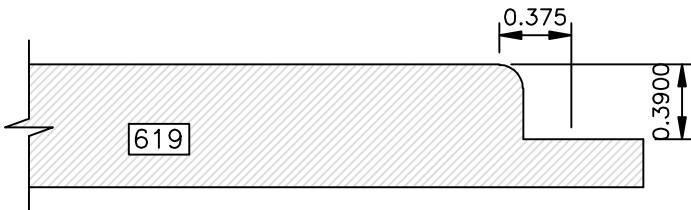
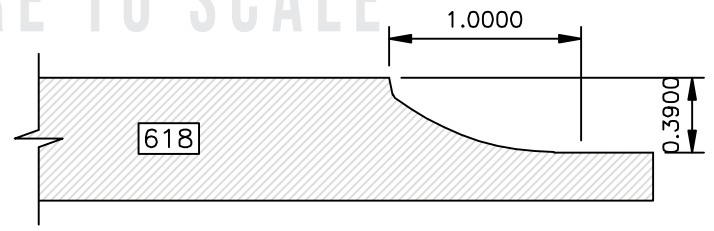
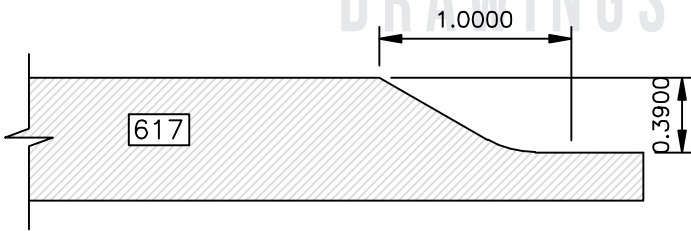

RAISED PANEL PROFILES

Go West!

When ordering veneer MDF panel, use 690 as the panel profile.

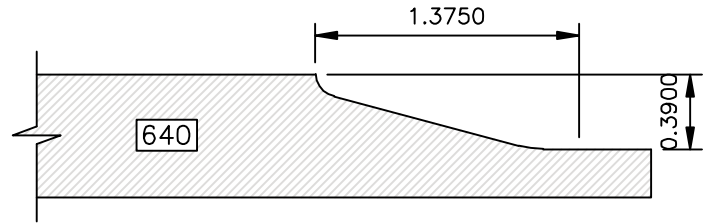
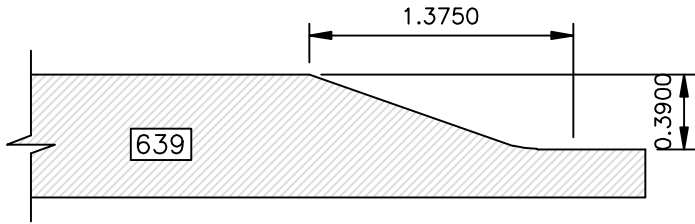
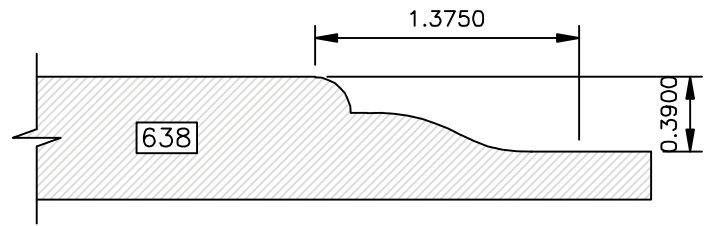
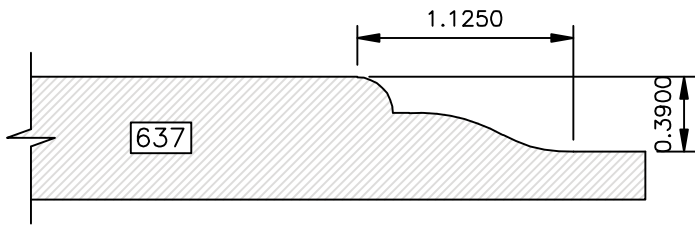
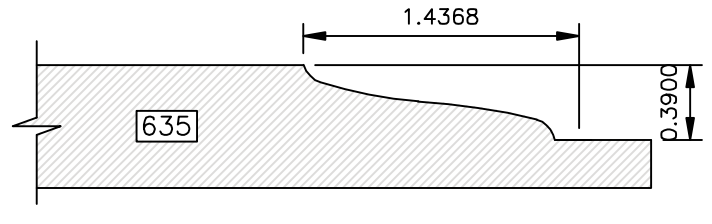
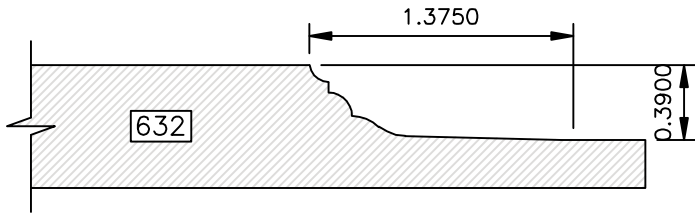
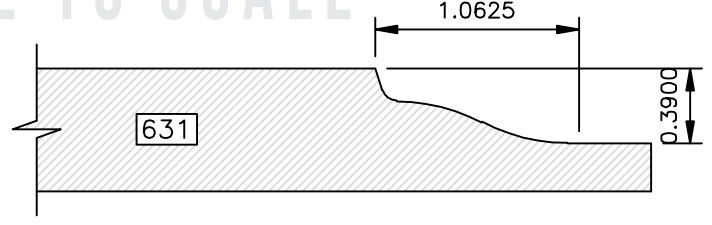
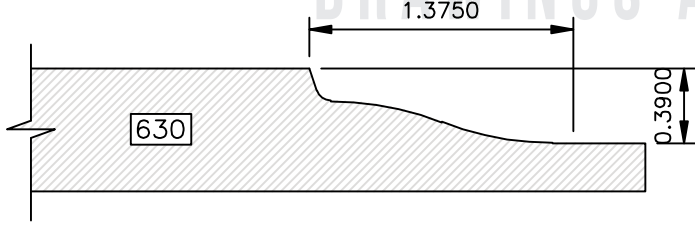
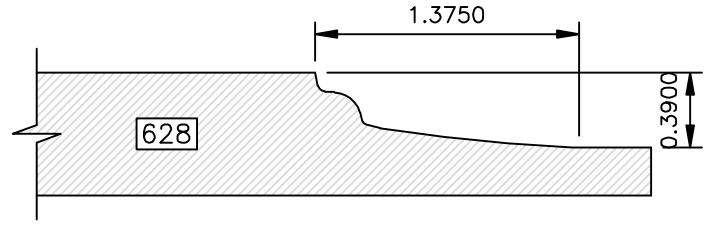
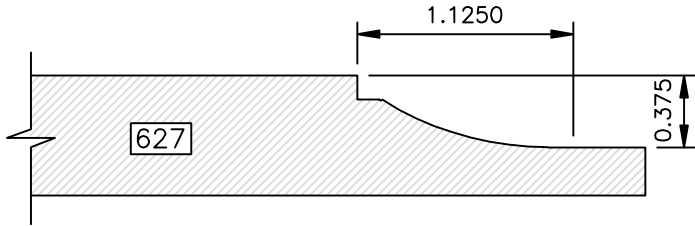
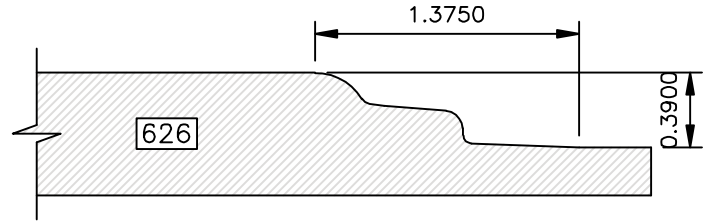
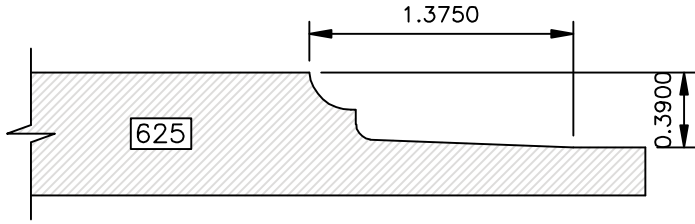

DRAWINGS ARE TO SCALE

Go West!

RAISED PANEL PROFILES

When ordering veneer MDF panel, use 690 as the panel profile.

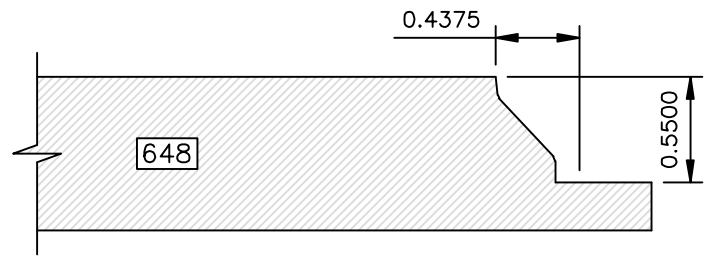
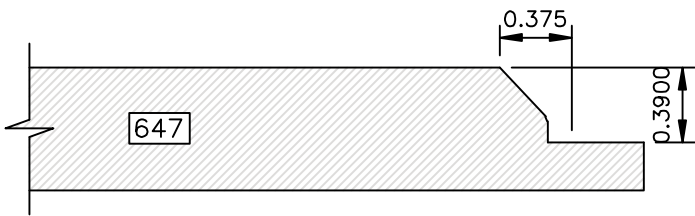
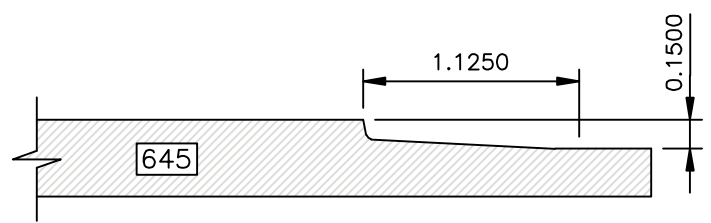
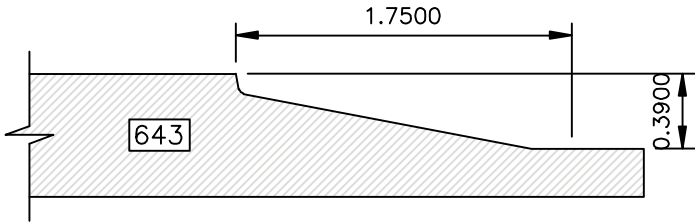
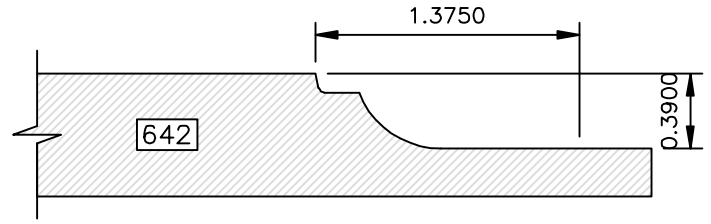
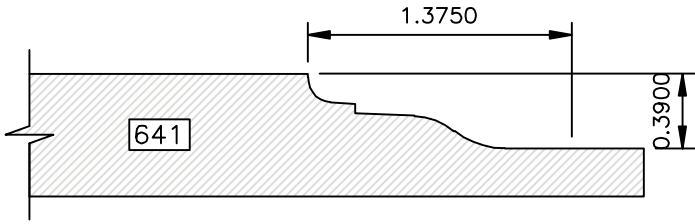

Available in 1" Thick Only

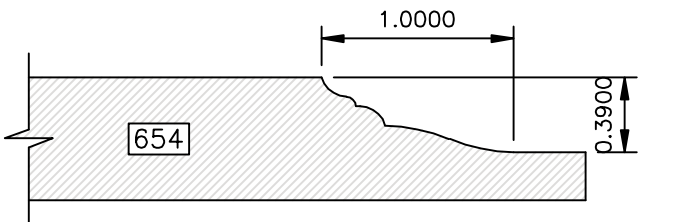
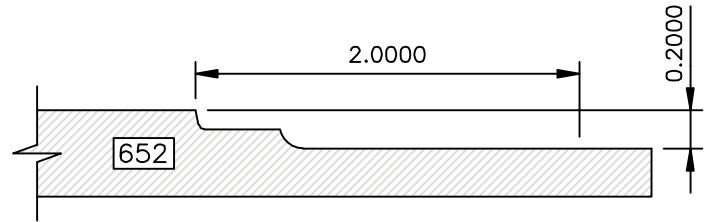
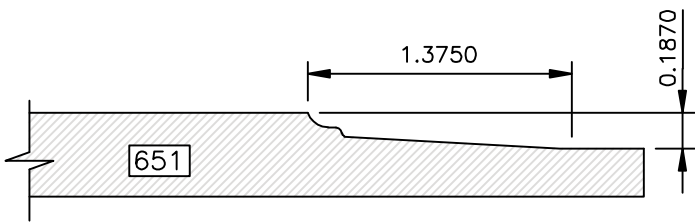
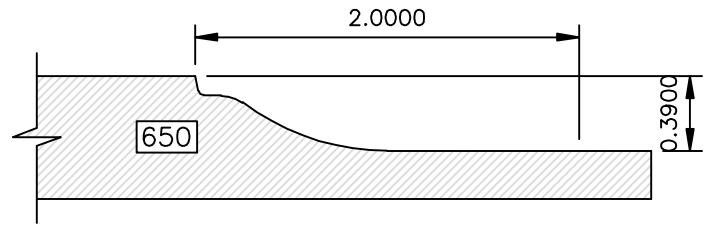
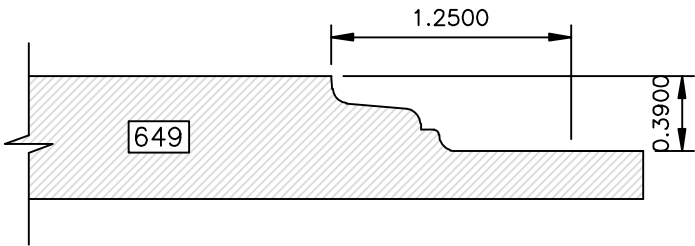

RAISED PANEL PROFILES

Go West!

When ordering veneer MDF panel, use 690 as the panel profile.

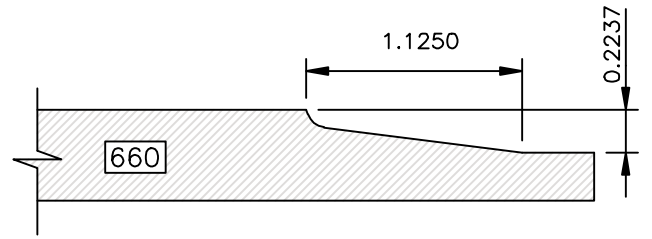
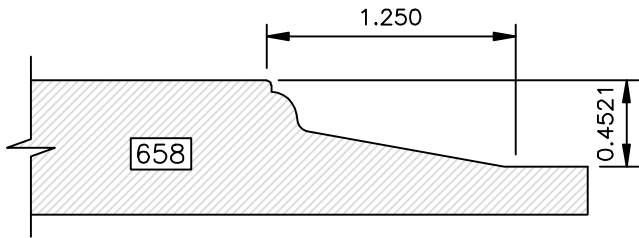
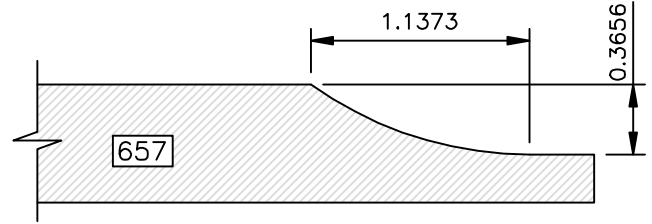
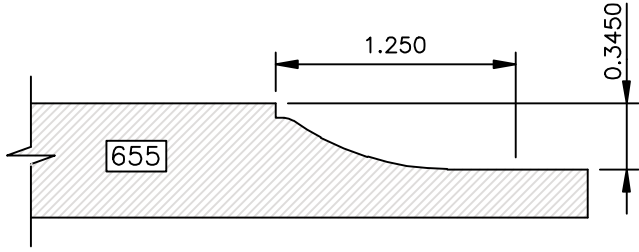

Available in 1" Thick Only

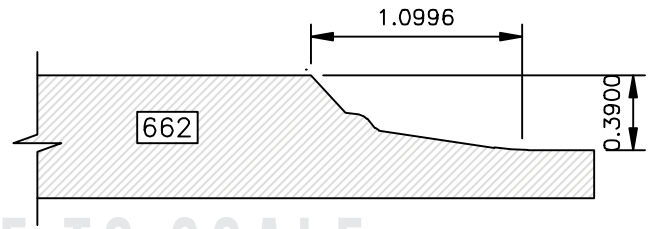
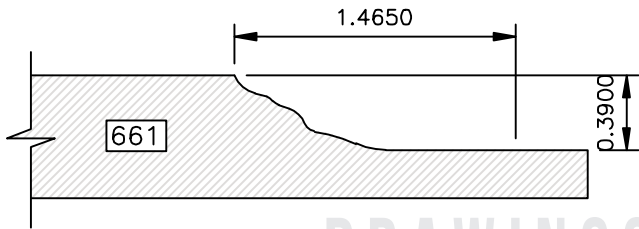

DRAWINGS ARE TO SCALE

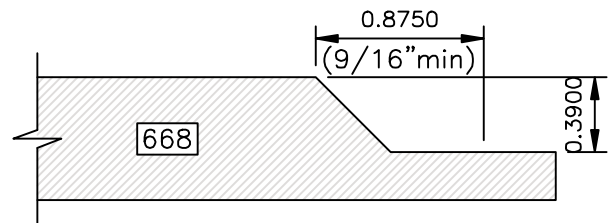
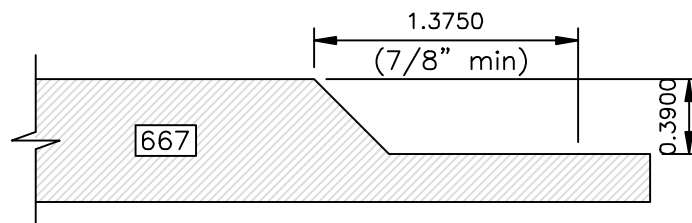
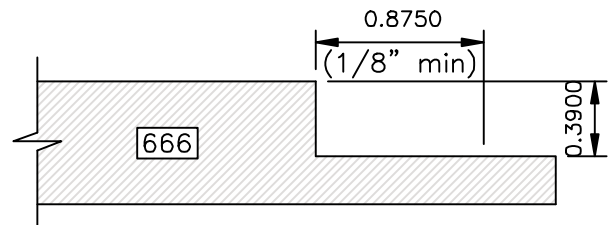
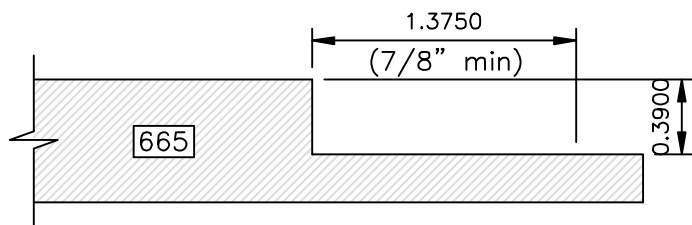
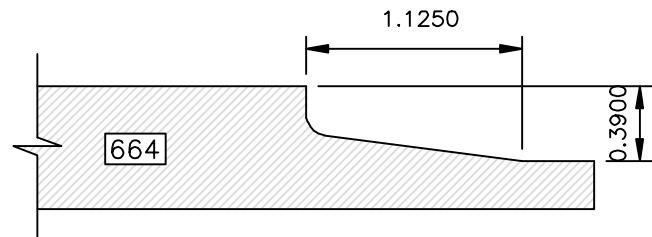
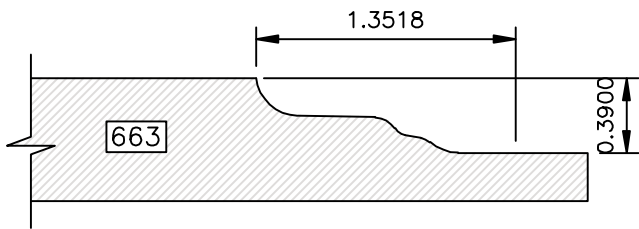

RAISED PANEL PROFILES

When ordering veneer MDF panel, use 690 as the panel profile.

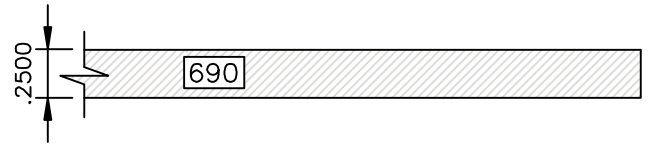
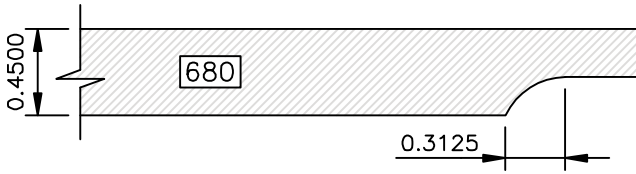

DRAWINGS ARE TO SCALE

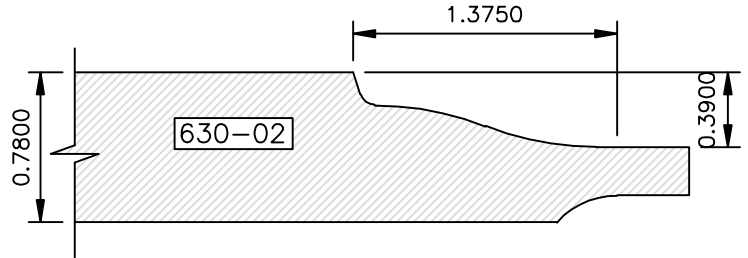
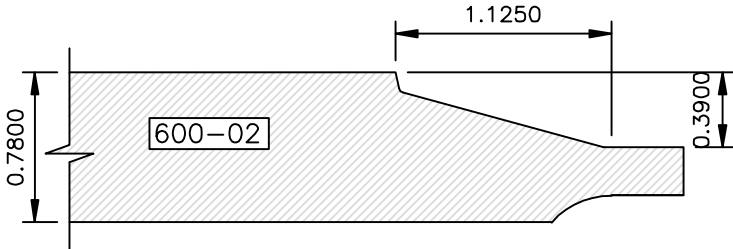

Most of our Panel Profiles are available with an “-02” option. The option adds additional thickness to the back of the panel. Two examples of this are shown above but we did not draw out the option for every available Panel Profile.